

(this part of the survey mutilated)

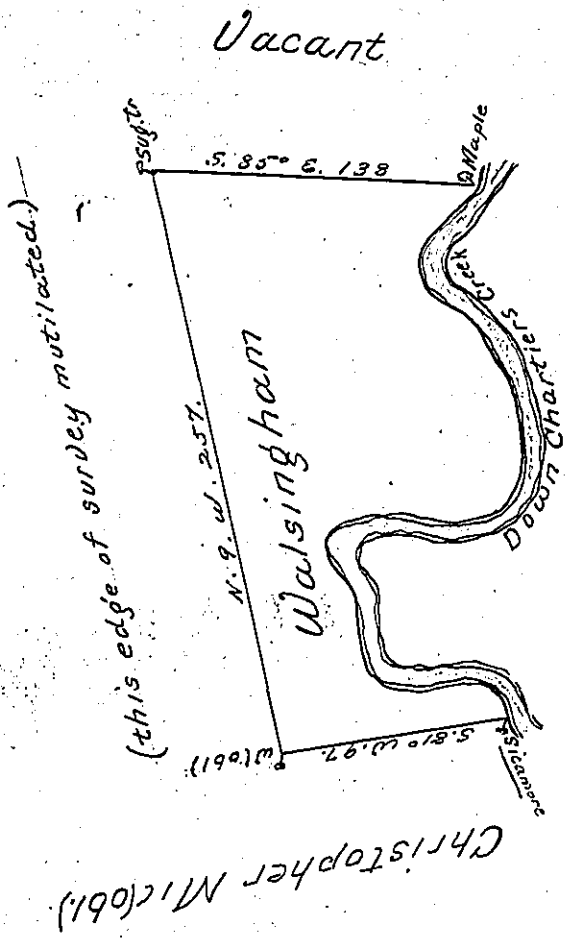

- S. 28° W. 18 p.
  - S. 61. W. 24 p.
  - S. 25. W. 12 p.
  - S. 40. E. 66 p.
  - South -- 50 p.
  - S. 73. W. 30 p.
  - N. 73. W. 22 p.
  - S. 79. W. 20 p.
  - S. 35. W. 24 p.
  - S. 33. E. 27 p.
  - S. 12. E. 20 p.
  - S. 45. E. 10 p.
  - S. 85. E. 32 p.
  - N. 65. E. 12 p.
  - S. 19. E. 10 p.
- 377 to a Sycamore

In pursuance of an order No. 1563 dated  
 3d. April 1769 the above is a draught of a tract of land  
 called Walsingham situated on the West side Mo-  
 nongahala, containing 126 acres with the usual all-  
 owance of 6 p.b. for roads, highways &c. Survey'd for  
 William Randles 30th. October 1769

by  
 James Hendricks

To John Lukens Esqr.  
 Surveyor General

IN TESTIMONY that the above is a copy of the original remaining on file in  
 the Department of Internal Affairs of Pennsylvania, made  
 conformably to an Act of Assembly approved the 16th day of  
 February, 1833, I have hereunto set my Hand and caused  
 the Seal of said Department to be affixed at Harrisburg,  
 this first day of October 1901

James W. Fatta  
 Secretary of Internal Affairs.